

DETALHE DO MURO DE CONTENÇÃO

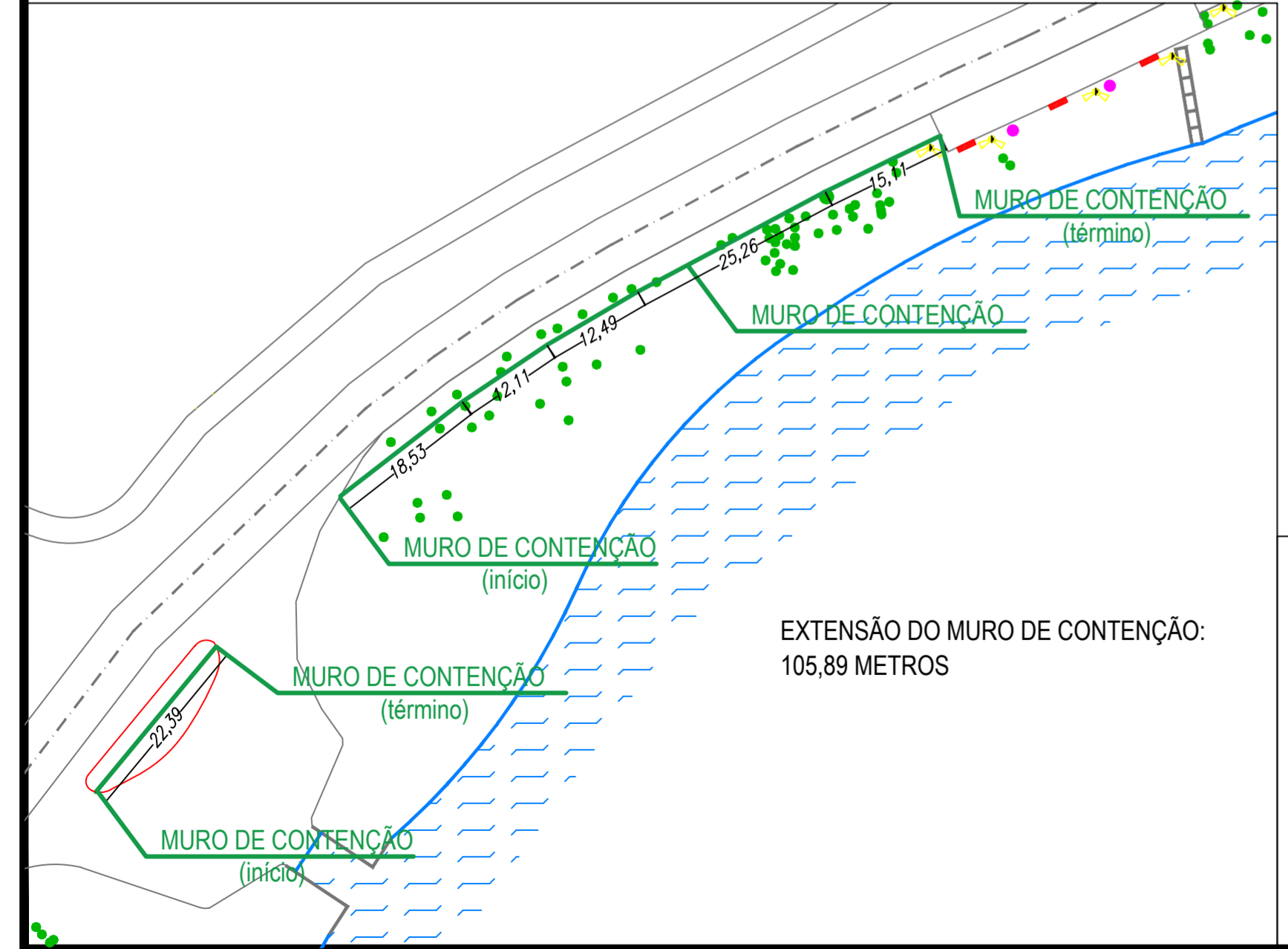

EXTENSÃO DO MURO DE CONTENÇÃO:
105,89 METROS

RAMPAS DE ACESSIBILIDADE

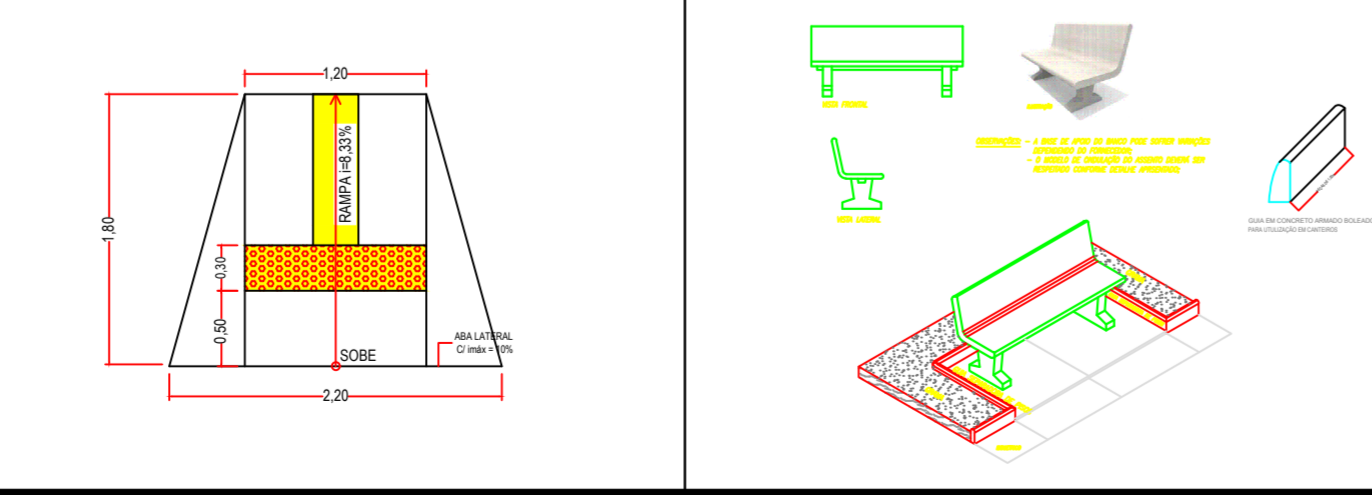

LEGENDA E CONVENÇÕES

AVENIDA / ESTRADA MUNICIPAL	GUIAS	RAMPAS
REPRESA MUNICIPAL EUCLIDES MORELLI	GUARDA-CORPO	ARVORE ISOLADA
POSTE	PV DE ESGOTO LOCALIZADO	PV DE AGUA LOCALIZADO
BANCO	POSTE DE ILUMINAÇÃO TIPO PETALA COM 2 LÂMPADAS DE LED	CONJUNTO DE LIXEIRAS

PROJETO BÁSICO

PROJETO BÁSICO DA CONSTRUÇÃO DE PISTA DE CAMINHADA NA AVENIDA RODOLPHO MORELLI

PREFEITURA MUNICIPAL DE STA. CRUZ DA CONCEIÇÃO

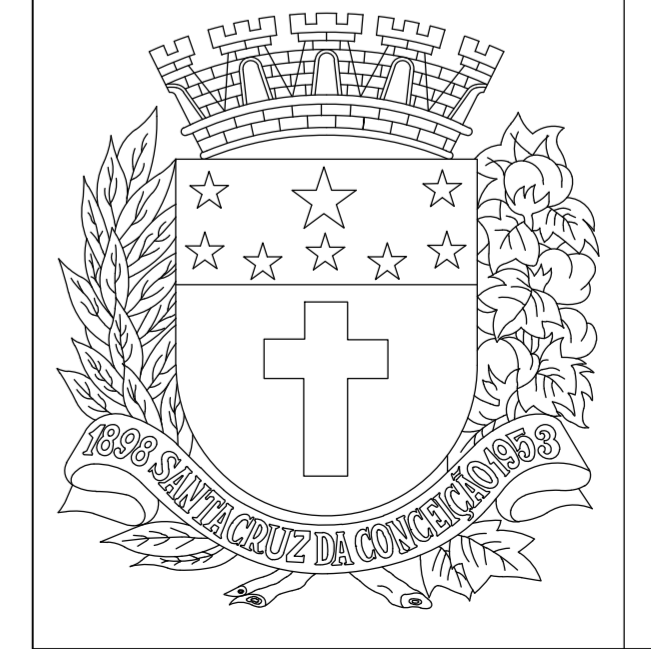

CARLOS EDUARDO ARANHA DE ALBUQUERQUE
PREFEITO MUNICIPAL

PEDRO FIGUEIREDO DE LIMA
ENGENHEIRO CIVIL
CREA/SP 5069543194
ART 28027230231787589

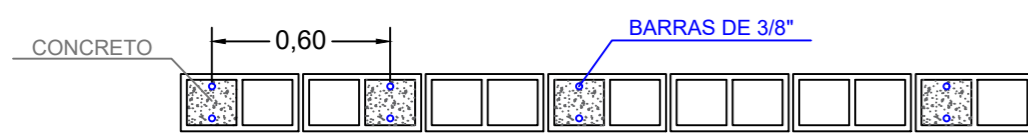
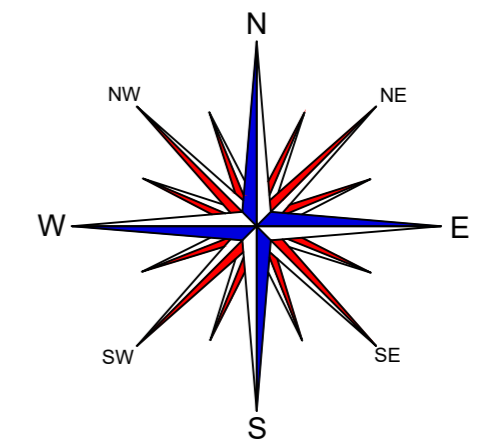
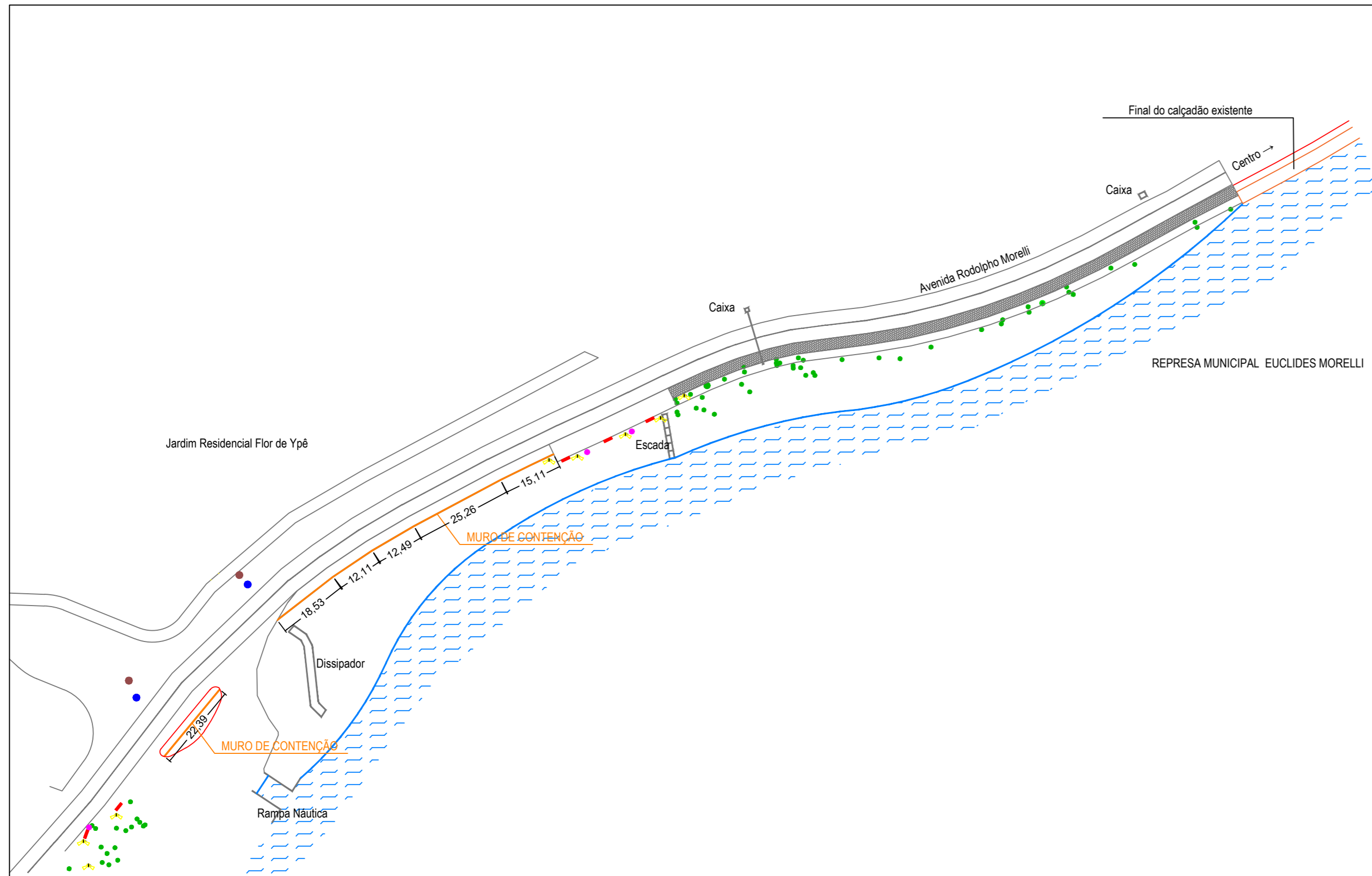

DETALHAMENTO MURO DE ARRIMO - GRAUTEADO
escala 1:25

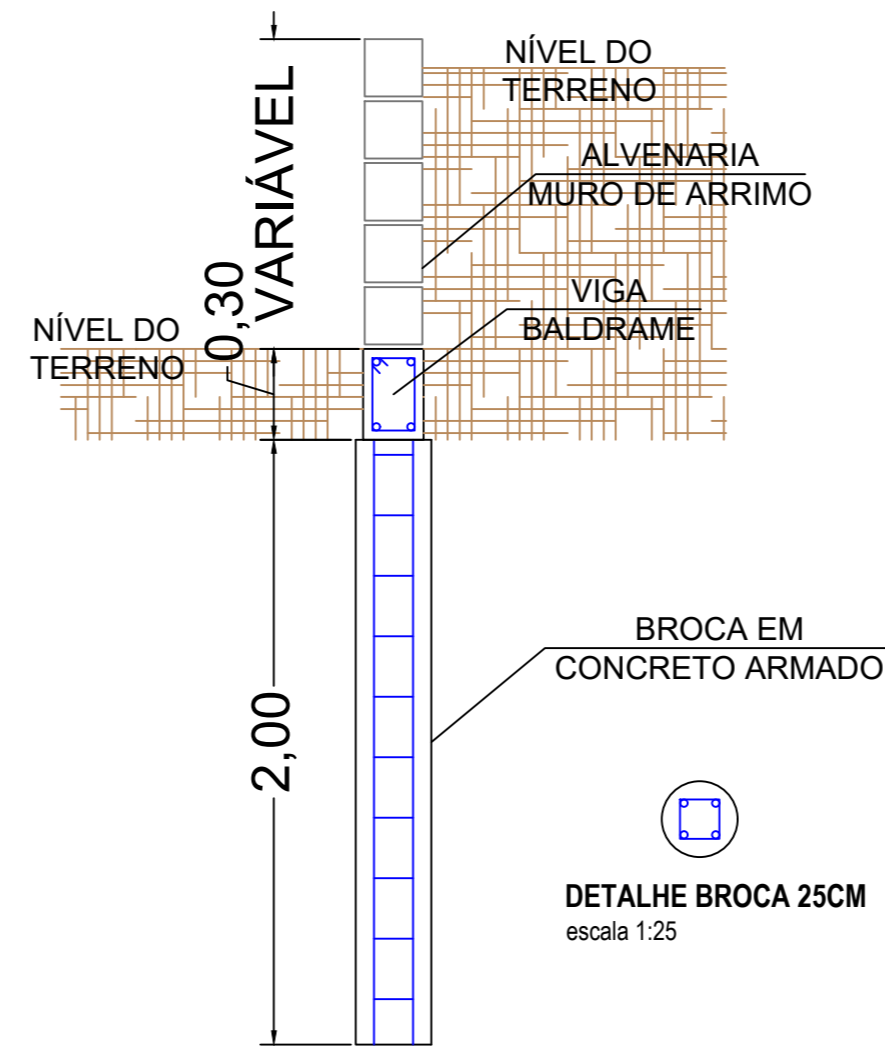

CORTE B-B (MURO DE CONTENÇÃO)
escala 1:25

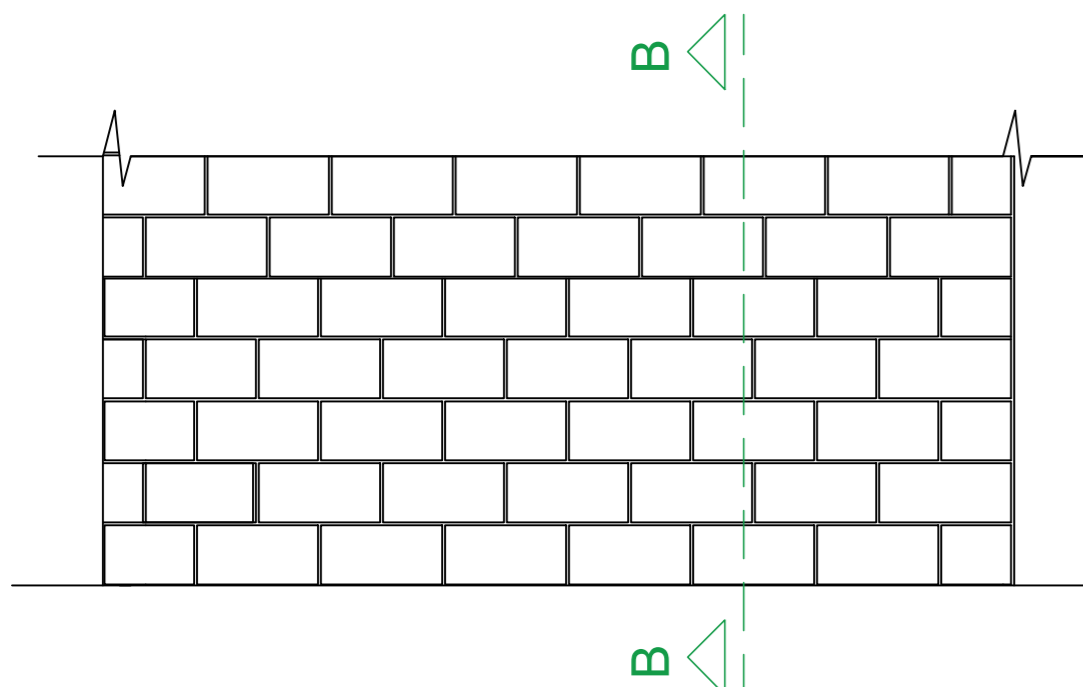

DETALHAMENTO DO MURO DE CONTENÇÃO
sem escala

PROJETO ESTRUTURAL

PROJETO DE LOCALIZAÇÃO, FUNDAÇÃO E ESTRUTURA DO MURO DE ARRIMO A SER EXECUTADO NA CONSTRUÇÃO DE PISTA DE CAMINHADA NA AVENIDA RODOLPHO MORELLI

PREFEITURA MUNICIPAL DE STA. CRUZ DA CONCEIÇÃO

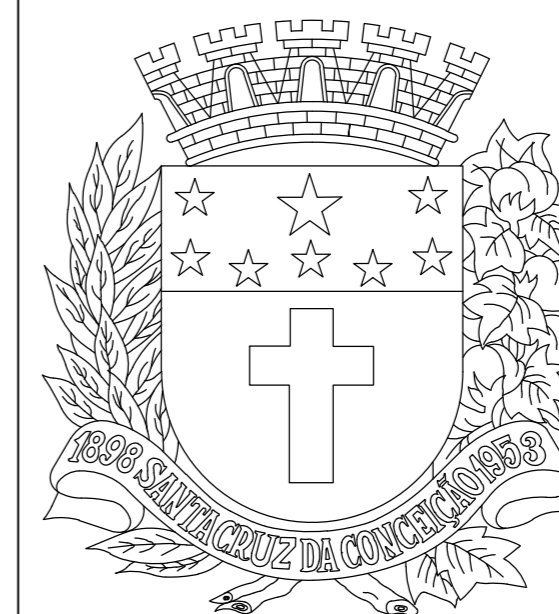

CARLOS EDUARDO ARANHA DE ALBUQUERQUE
PREFEITO MUNICIPAL

PEDRO FIGUEIREDO DE LIMA
ENGENHEIRO CIVIL
CREA/SP 5069543194
ART 28027230231787589

LEGENDA E CONVENÇÕES		
AVENIDA / ESTRADA MUNICIPAL	GUIAS	CAIXA DE PASSAGEM
REPRESA MUNICIPAL EUCLIDES MORELLI	GUARDA-CORPO	ÁRVORE ISOLADA
POSTE	PV DE ESGOTO LOCALIZADO	PV DE ÁGUA LOCALIZADO
BANCO	POSTE DE ILUMINAÇÃO TIPO FETIL COM 3 LÂMPADAS DE LED	LIXEIRA EM MADEIRA E AÇO

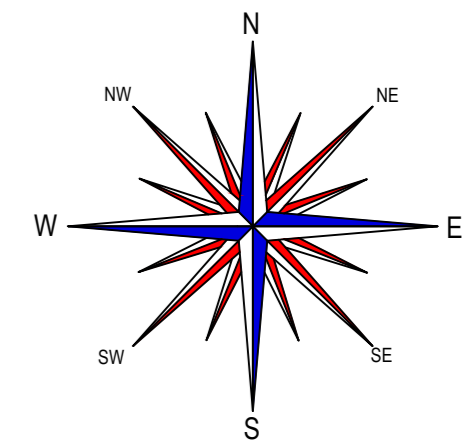
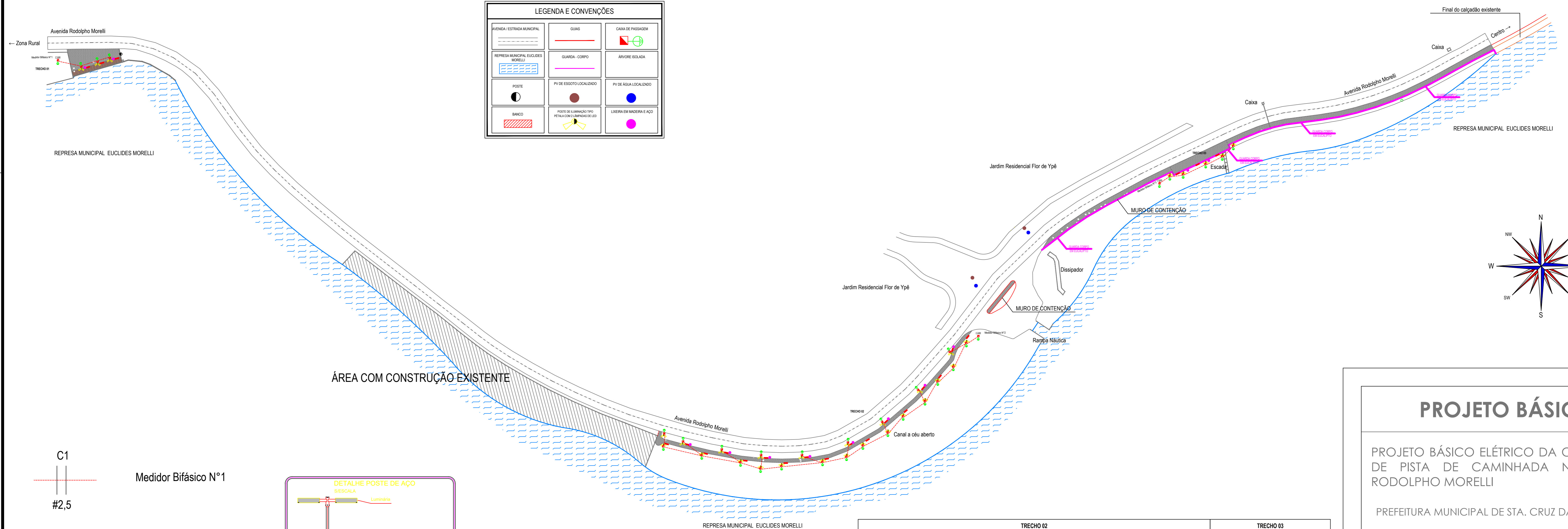

ÁREA COM CONSTRUÇÃO EXISTENTE

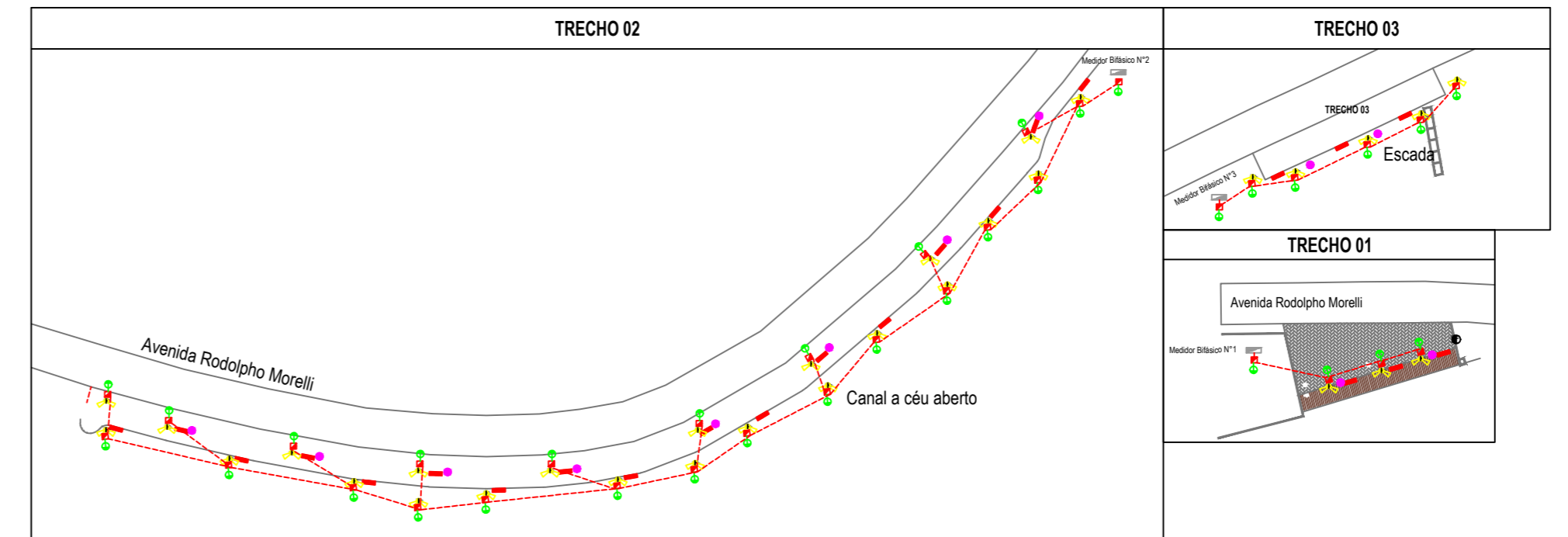
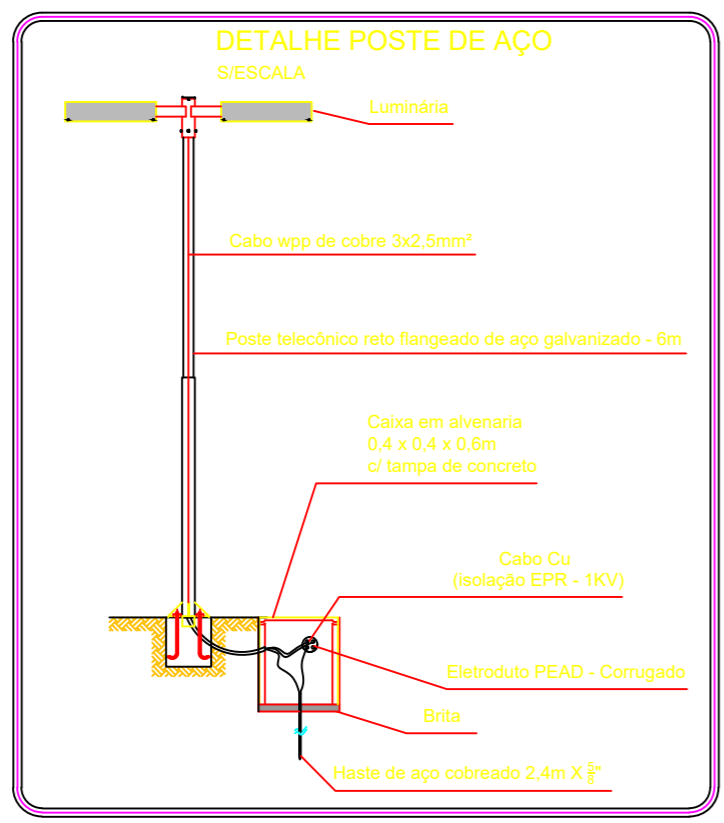
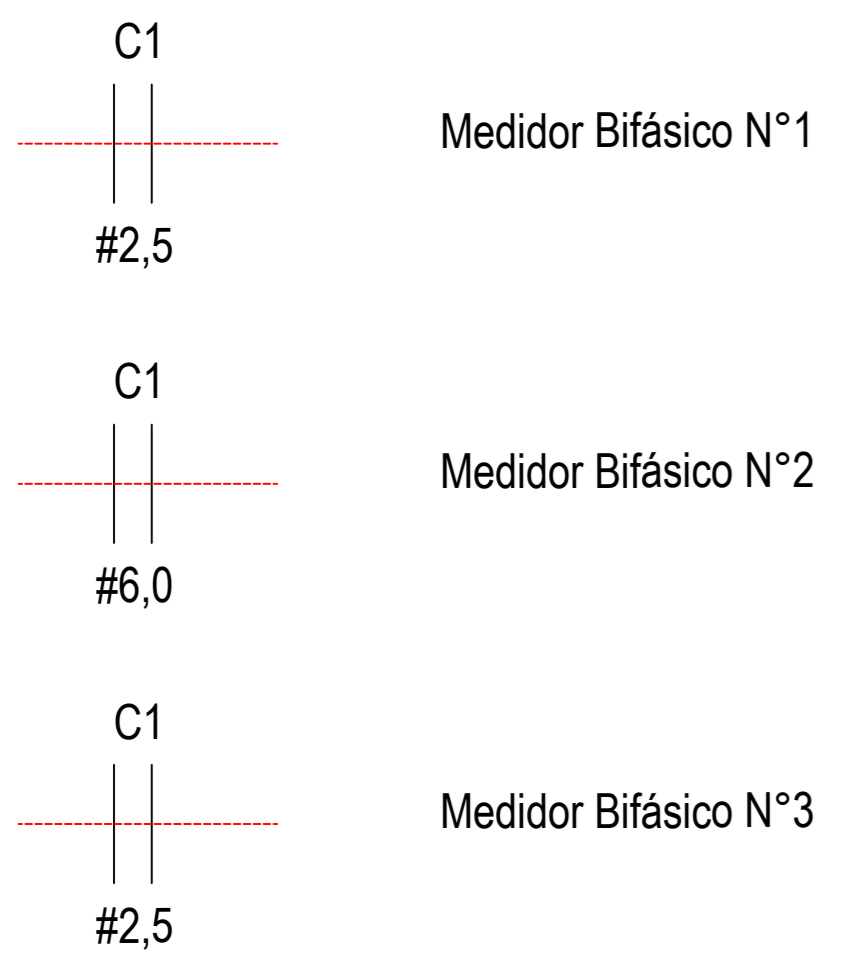

PROJETO BÁSICO

PROJETO BÁSICO ELÉTRICO DA CONSTRUÇÃO DE PISTA DE CAMINHADA NA AVENIDA RODOLPHO MORELLI

PREFEITURA MUNICIPAL DE STA. CRUZ DA CONCEIÇÃO



CARLOS EDUARDO ARANHA DE ALBUQUERQUE
PREFEITO MUNICIPAL

PEDRO FIGUEIREDO DE LIMA
ENGENHEIRO CIVIL
CREA/SP 5069543194
ART 28027230231787589

Avenida Rodolpho Morelli

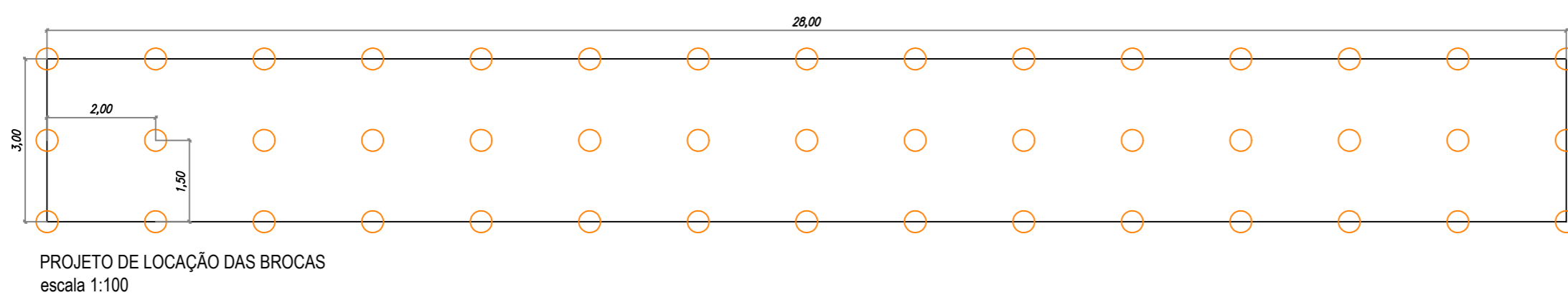
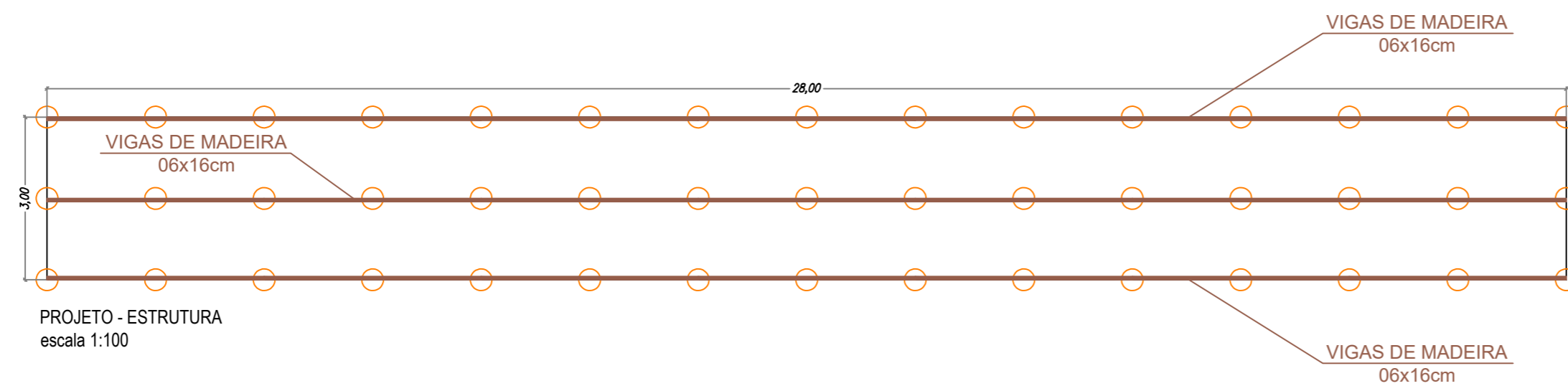
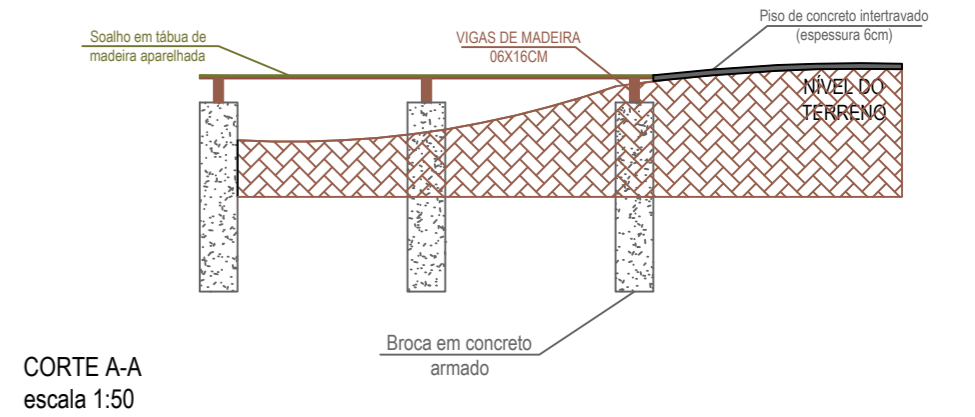
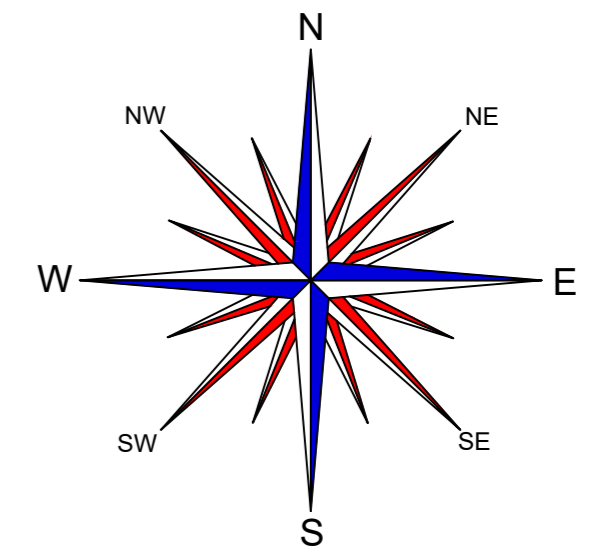
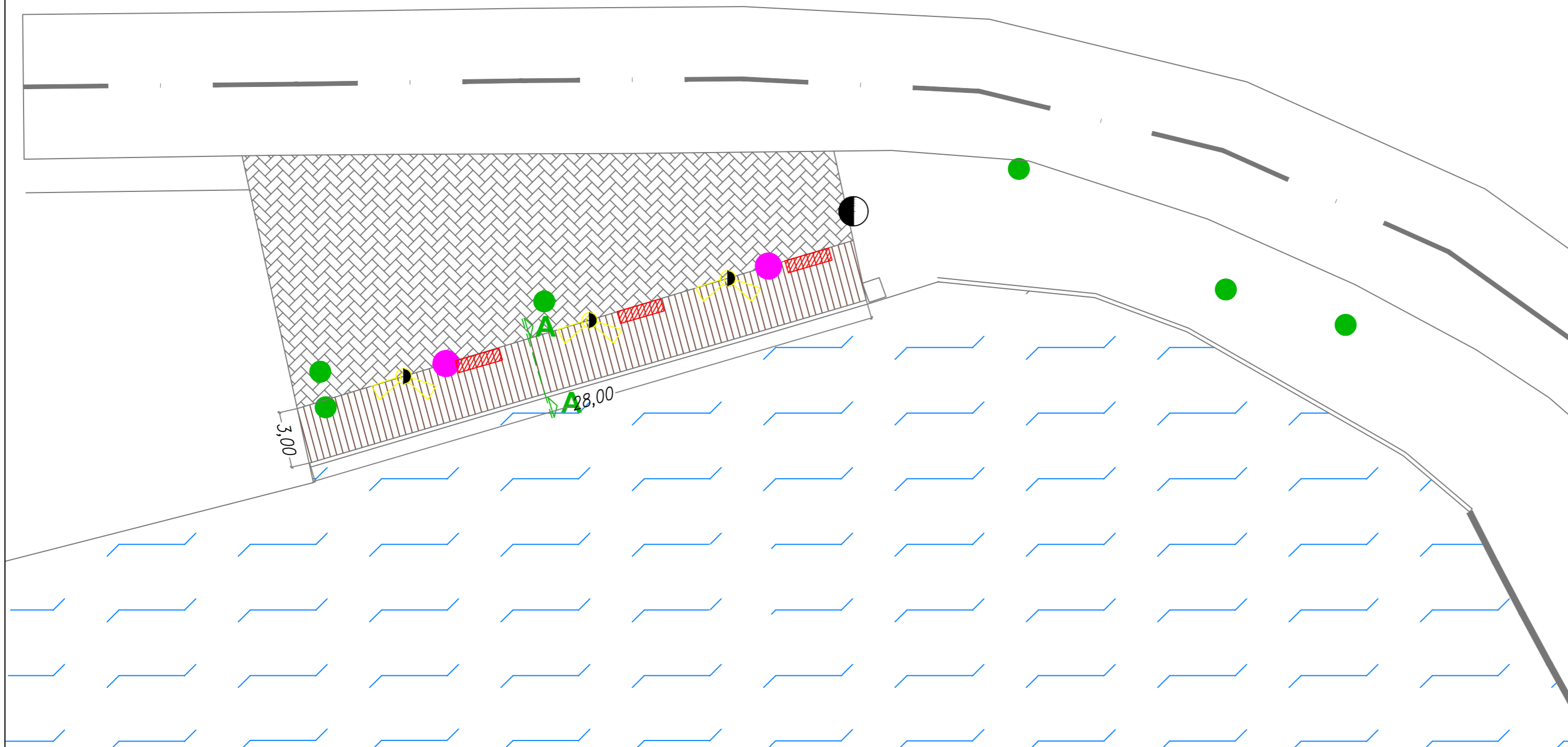

PROJETO EXECUTIVO

PROJETO DE EXECUÇÃO DO DECK DE MADEIRA A SER EXECUTADO NA AMPLIAÇÃO DO CALÇADÃO NO ENTORNO DA ORLA DA REPRESA "EUCLIDES MORELLI"

PREFEITURA MUNICIPAL DE STA. CRUZ DA CONCEIÇÃO

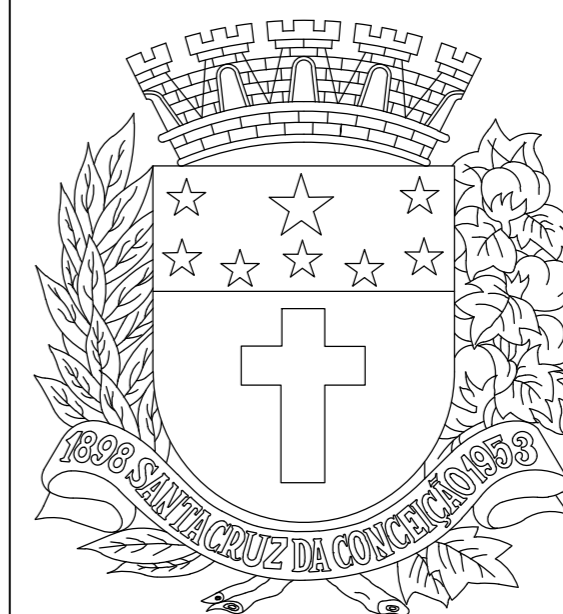

CARLOS EDUARDO ARANHA DE ALBUQUERQUE
PREFEITO MUNICIPAL

PEDRO FIGUEIREDO DE LIMA
ENGENHEIRO CIVIL
CREA/SP 5069543194
ART 28027230231787589

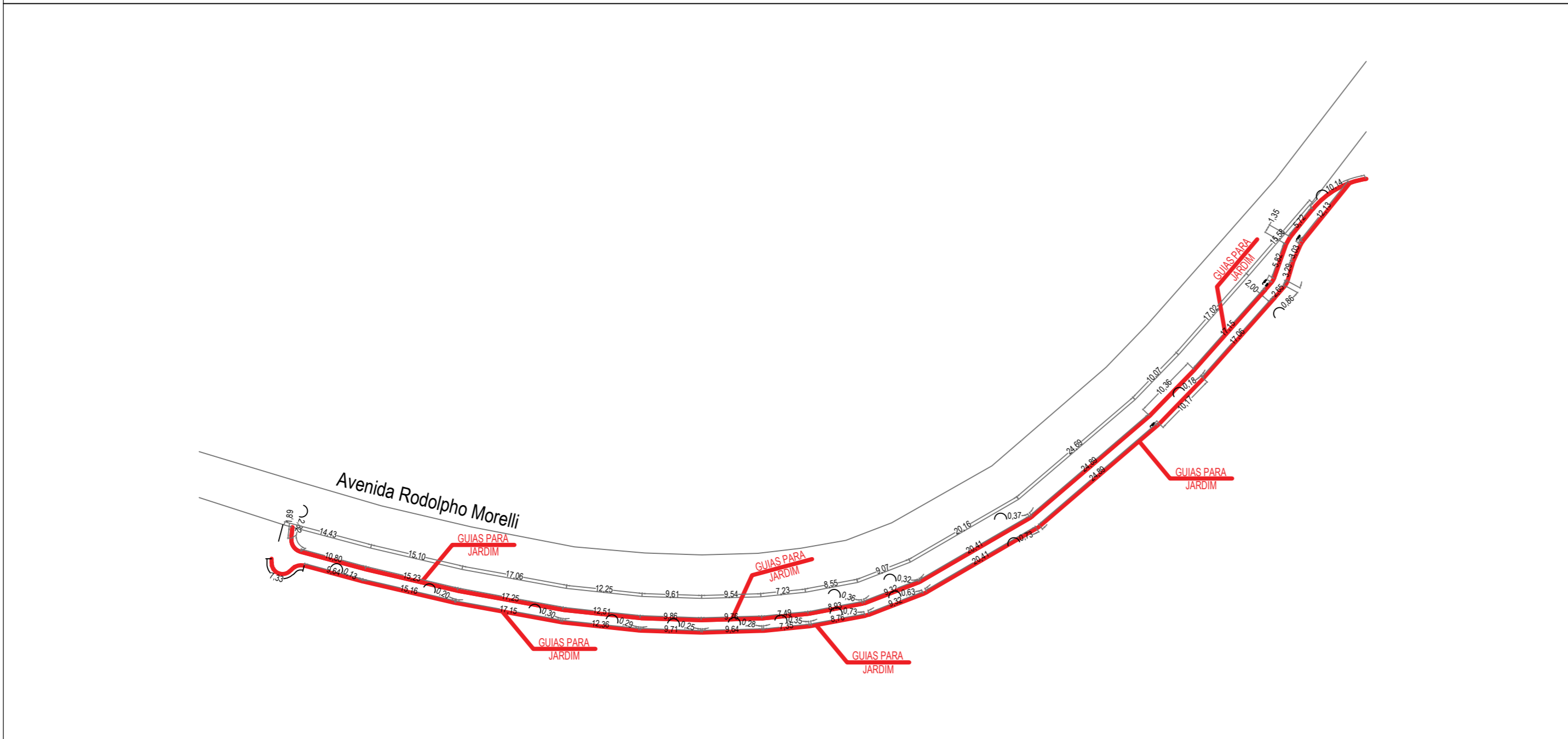
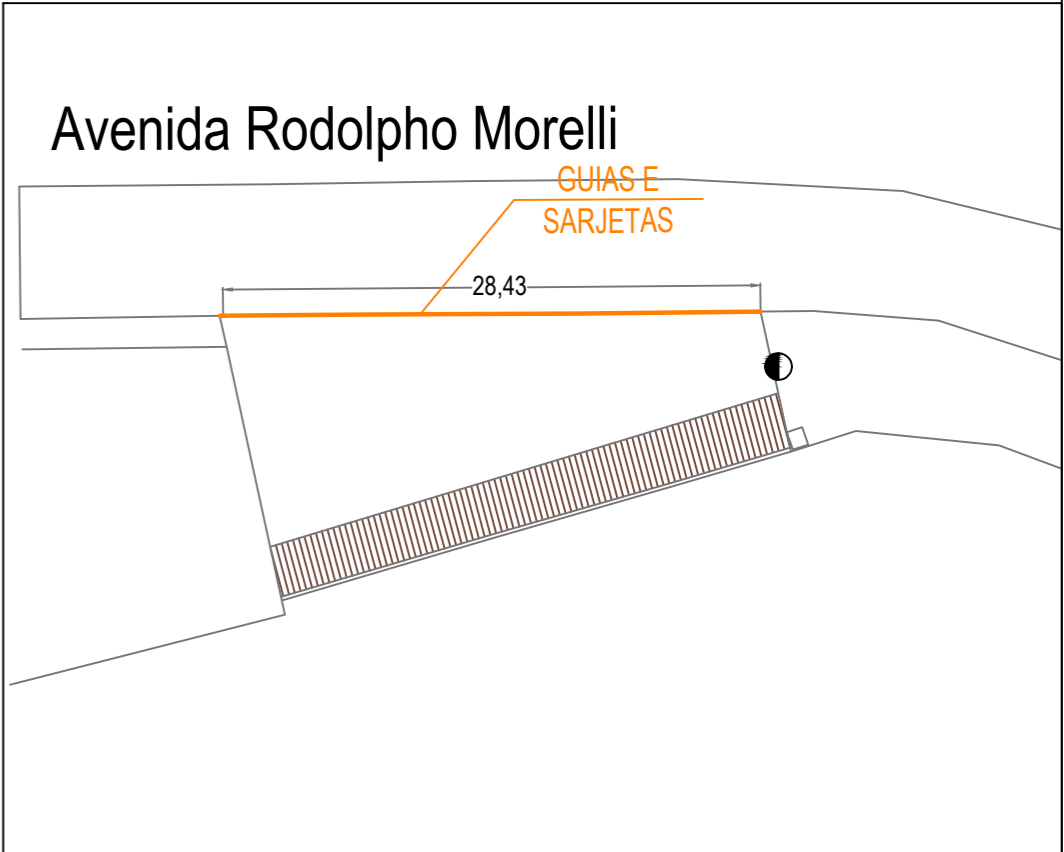
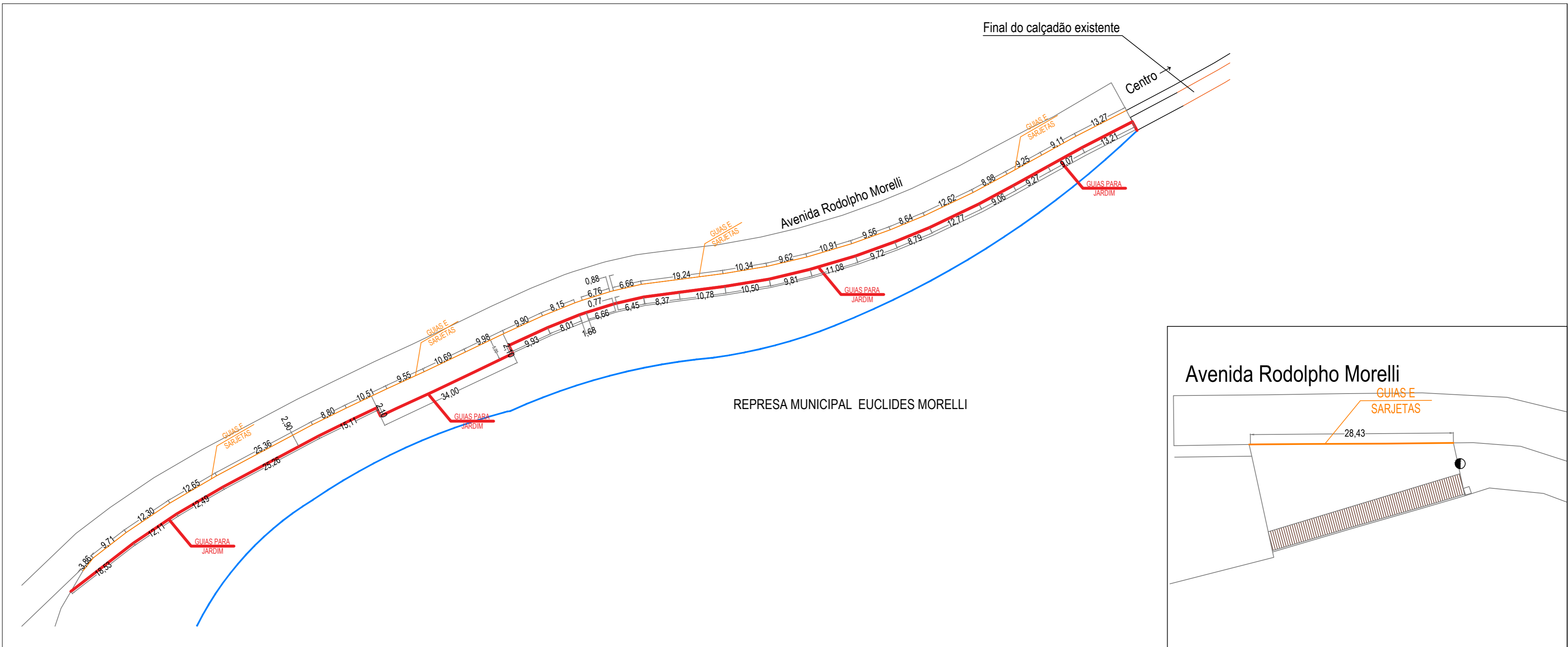

PROJETO EXECUTIVO

PROJETO DE EXECUÇÃO DE GUIAS À SEREM EXECUTADAS NA AMPLIAÇÃO DO CALÇADÃO NO ENTORNO DA ORLA DA REPRESA "EUCLIDES MORELLI"

PREFEITURA MUNICIPAL DE STA. CRUZ DA CONCEIÇÃO



CARLOS EDUARDO ARANHA DE ALBUQUERQUE
PREFEITO MUNICIPAL

PEDRO FIGUEIREDO DE LIMA
ENGENHEIRO CIVIL
CREA/SP 5069543194
ART 28027230231787589